

Network Camera

Installation Manual

Before operating the unit, please read this manual thoroughly and retain it for future reference.

SNC-VM602R/VM632R

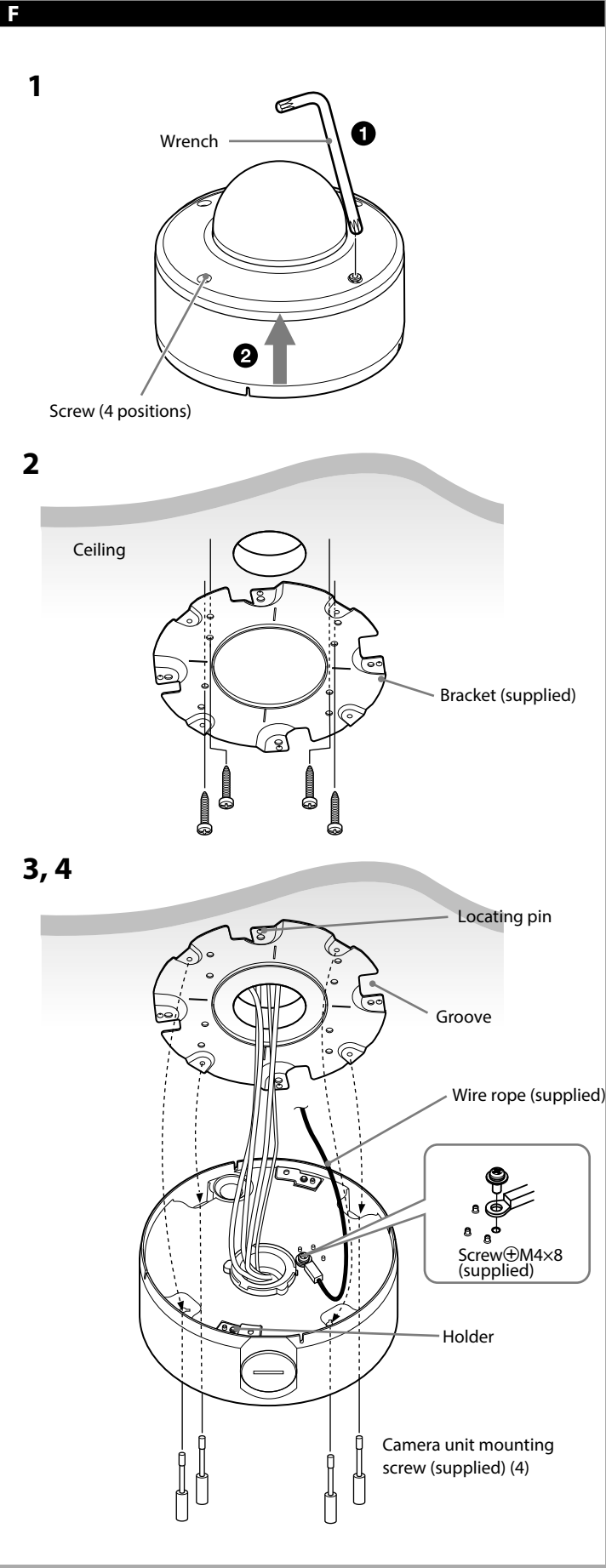
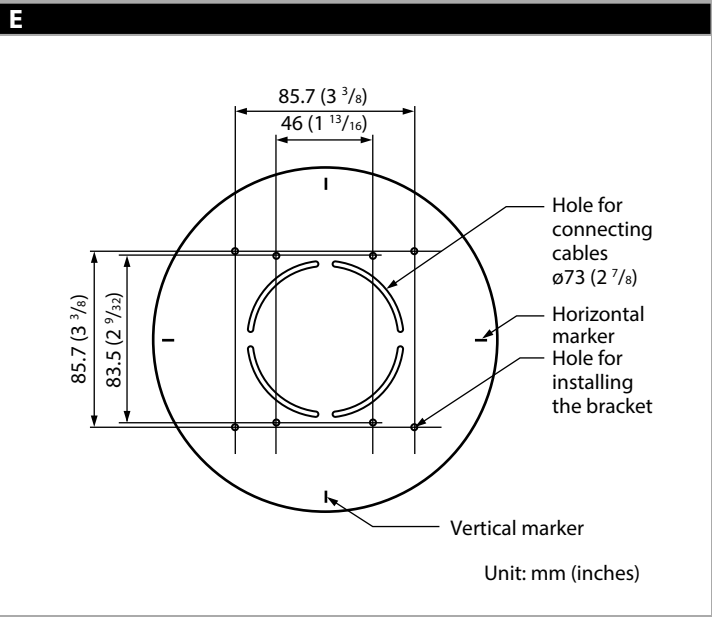
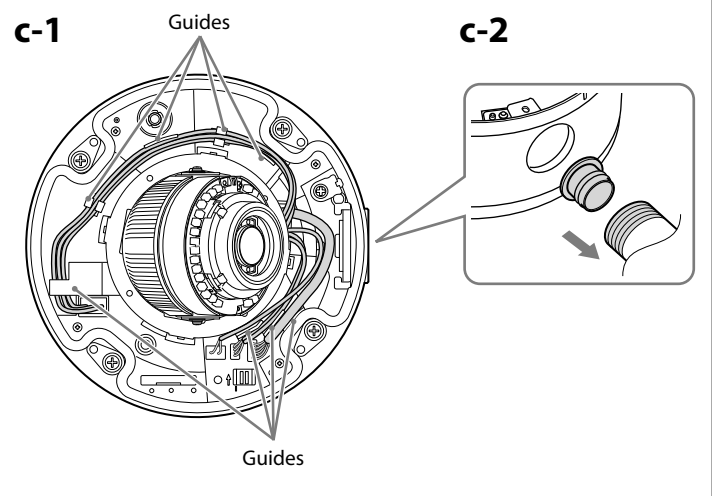
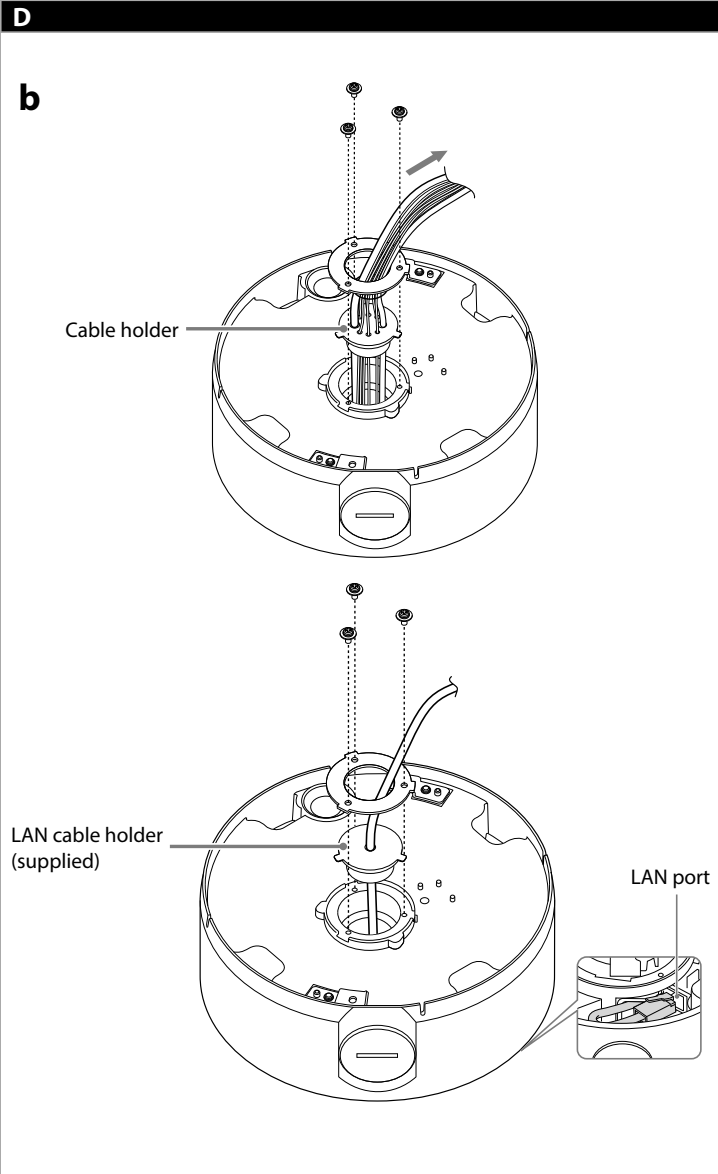
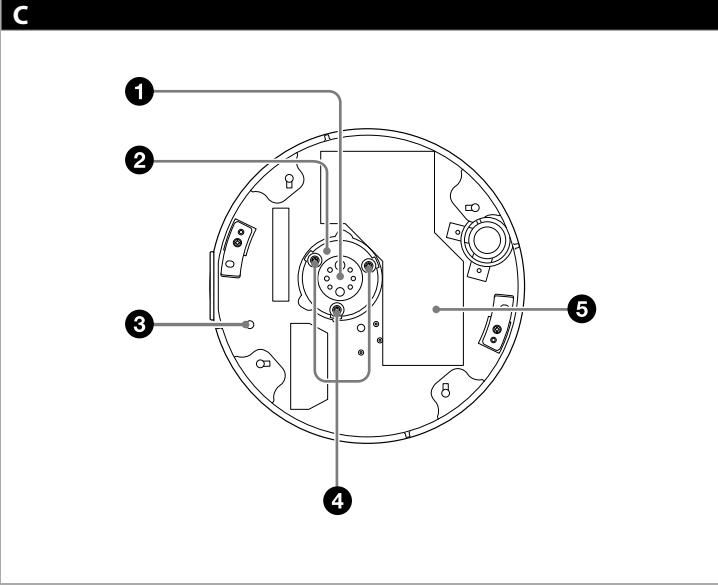
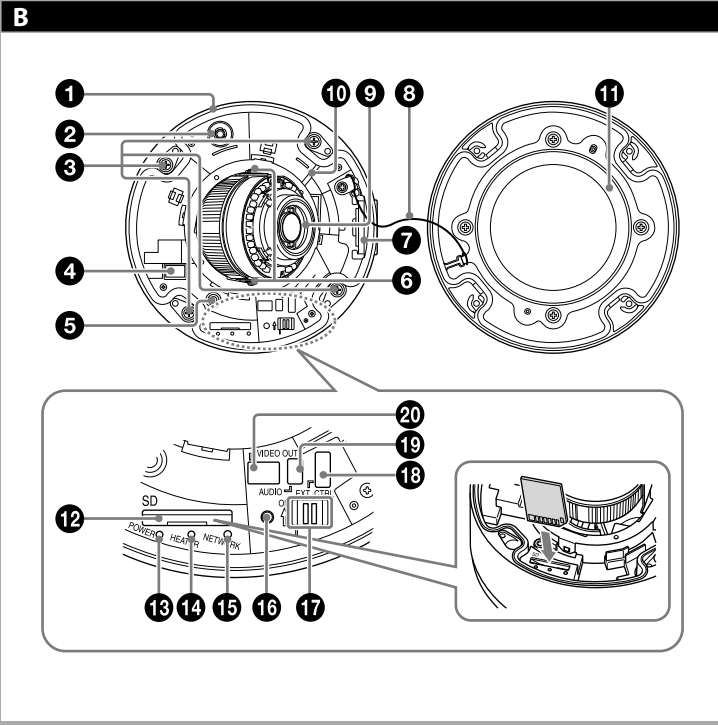
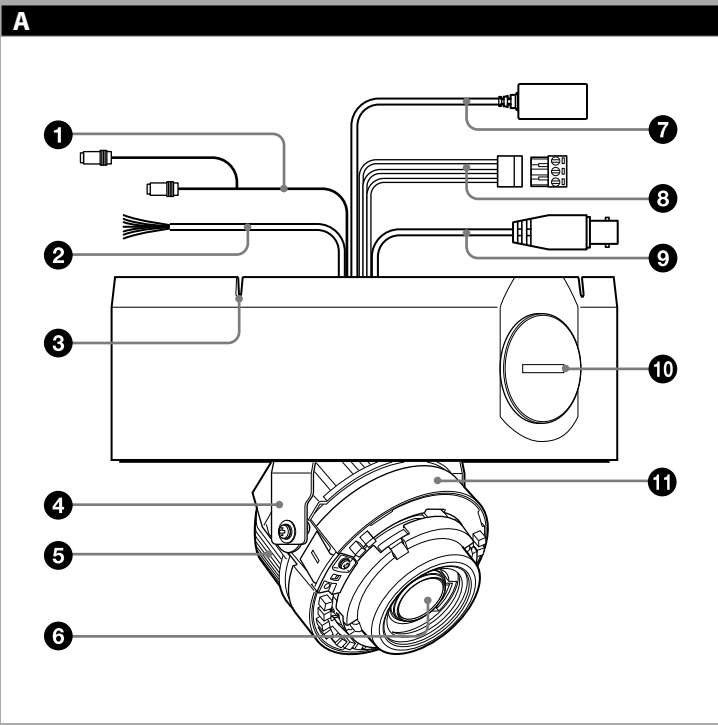
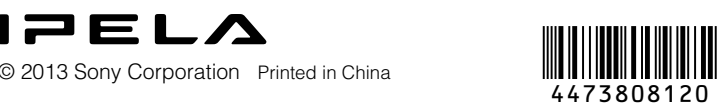

About the Manuals

Installation Manual (this document)

This Installation Manual describes the names and functions of parts and controls of the Network Camera, gives connection examples and explains how to set up the camera. Be sure to read the Installation Manual before operating.

SNC easy IP Setup Guide (stored in the CD-ROM)

User's Guide/Application Guide (Web)

The User's Guide describes how to set up the camera and how to control the camera via a Web browser. After installing and connecting the camera correctly, operate referring to this User's Guide.

Using the Software

The supplied CD-ROM includes the setup program for assigning an IP address. The information for how to set up an IP address is also included in the disc in PDF format.

User's Guide and Application Guide can be downloaded from the disc, or the following URL:
<http://www.sony.net/ipela/snc>

Using the CD-ROM manual

The manual can be read on a computer with Adobe Reader installed. You can download Adobe Reader free from the Adobe website.

- 1 Open the index.html file in the CD-ROM.
- 2 Select and click on the manual that you want to read.

Note

If you have lost or damaged the CD-ROM, you can purchase a new one from your Sony dealer or Sony service counter.

Adobe and Acrobat Reader are trademarks of Adobe Systems Incorporated in the United States and/or other countries.

Assigning the IP address

Assign the IP address using the setup program in the supplied CD-ROM. For details on how to set up the IP address, see SNC easy IP Setup Guide.

Location and Function of Part

The figure shows the camera without the dome casing.

Side

- 1 Audio cable (supplied and connected to the camera at the factory)
The connector with the longer cable (SP) is used for the line output connector, and the shorter cable (MIC) is used for the microphone/line input connector.
 - SP terminal (minijack, monaural)
Connect a commercially available speaker system with a built-in amplifier.
 - MIC terminal (minijack, monaural)
Connect a commercially available microphone. This jack supports plugin-power microphones (rated voltage: 2.5 V DC).

I/O (Input/Output) cable (supplied and connected to the camera at the factory)

This cable is provided with two sensor inputs and two alarm outputs. The wires of the cable control the following signals.

Color of wire	Name
Red	Sensor In 1+
White	Sensor In 2+
Black	Sensor In – (GND)
Yellow	Alarm Out 1+
Brown	Alarm Out 1–
Green	Alarm Out 2+
Blue	Alarm Out 2–

For details on each function and required settings, see the User's Guide. For the wiring, see "Connecting the I/O cable" overleaf.

Wiring slit

Feed the wire rope through this. For details, see "Installing the Camera."

Base (PAN)

Camera block

Lens

LAN cable (RJ-45) (supplied and connected to the camera at the factory)

Connect this cable to a hub or computer on the 10BASE-T or 100BASE-TX network using a commercially available network cable (UTP, category 5).

Power input cable (supplied and connected to the camera at the factory)

Connect this cable to a 24 V AC or 12 V DC power supply system. You can screw an extension cable in the connector tip attached at the end of the cable. Connect GND to the FG terminal (center of 3-pin connector). See illustration **A** overleaf.

BNC cable (supplied and connected to the camera at the factory)

Side conduit hole (3/4 inches NPT or M27 (2.0 mm (3/32 inches)-pitched, hole diameter ø27 mm (1 1/8 inches)))

Connect a pipe to this hole. There is a conduit hole on the side of the camera unit. The conduit hole cover is installed in the side conduit hole at the factory. Remove the cover as needed and connect the pipe to the hole. An M25 cable gland can be connected to the hole by removing the nut inside the camera unit.

Note

Take care not to trap the cables between the camera and the ceiling or the wall. If the cable is trapped, it may cause a fire or electric shock due to breaking.

Camera head

Inside

Camera unit

ZOOM/FOCUS switch

Use this switch to adjust lens' zoom and focus. Slide the switch lever to select the desired function.
[W] WIDE: Zoom out
[T] TELE: Zoom in
[N] NEAR: Focus on a nearby subject
[F] FAR: Focus on a distant subject
Hold down the center of the ZOOM/FOCUS switch for a moment to focus automatically.

Camera unit mounting screws (four positions)

AC / DC IN (power input) connector

Connect the supplied power input cable to this connector.

MONITOR output jack

Connect this jack to a video input connector of a video monitor. You can adjust the camera or lens while looking at the image on the video monitor. After adjusting the camera or lens, disconnect the cable.

Camera block fixing screws (tilt) (two positions)

Firstly, loosen the screws and point the camera block in the desired direction, then tighten the screws to secure in place.

Nut (3/4 inches NPT or M27 (2.0 mm (3/32 inches)-pitched))

Safety cord

This cord prevents the dome casing from falling off the unit.

Δ TOP mark

Indicates the image direction.

LAN network port (RJ-45)

Connect a commercially available network cable (UTP, category 5) to communicate with a network or PoE/PoE+ system. For details on connection, see the Instruction Manual of the power supply equipment. (*PoE/PoE+ stands for Power over Ethernet. It is pursuant to IEEE802.3at.)

Dome casing

The dome cover is made of polycarbonate. A waterproof rubber gasket is provided on the joint surface to the unit.

SD card slot

This slot is used for optional SD memory cards. Image data in the camera can be recorded to a memory card by inserting it into the slot. Gently insert an SD card in (see illustration) until it clicks into place. This unit is only compatible with SD and SDHC memory cards.

Note

For inquiries regarding verified SD memory cards, contact your authorized Sony dealer.

POWER indicator (Green)

When the power is supplied to the camera, the camera starts checking the system. If the system is normal, this indicator lights up.

HEATER indicator (Green)

The indicator lights up in green when the built-in heater is working normally.

NETWORK indicator (Green/Orange)

The indicator lights up or flashes when the camera is connected to the network. The indicator is off when the camera is not connected to the network.

Reset switch

To reset the camera to the factory default settings, hold down this switch with a point and supply the power to the camera.

Mode setting DIP switches

Switch No.	1	2
	VIDEO	POWER
Up (ON)	PAL	PoE+, AC, DC
Down (OFF)	NTSC	PoE

- 1 VIDEO (NTSC/PAL) switch (Initial setting: NTSC)
Switches the video output. After setting the switch, reboot the camera unit.
- 2 POWER (PoE+, AC, DC/PoE) switch (Initial setting: PoE+, AC, DC)
Switch PoE+, AC, DC/PoE, depending on the power source you are using.

Note

When power is supplied by IEEE802.3at (PoE+) equipment, if the switch is set to PoE, the range of activation and operating temperature is limited. When power is supplied by IEEE802.3af (PoE) equipment, if the switch is set to PoE+, the camera will not work properly. When power is supplied from the AC or DC source and if the switch is set to PoE, the heater will not work. Note that if you use the camera in a low temperature, the camera may not work.

EXT CTRL (external control input/output) connector

Connect the supplied I/O cable to this connector.

AUDIO connector

Connect the supplied audio cable to this connector.

VIDEO OUT (video output) connector

Connect the supplied BNC cable to this connector.

Bottom

Cable holder (supplied and connected to the camera at the factory)

Packing for waterproofing the cables.

Holder plate

Fixes the cable holder.

GND

Ground the camera when you install it.

Note

Use the supplied Screws Ⓞ (M4 × 8)

Holder plate fixing screws (three positions)

Fixes the holder plate.

Rating label

Shows the name of this camera and its electric rating.

Preparations

Change connections and cable wiring

All the supplied cables are connected to the camera at the factory. To change connections and cable wiring to suit your requirements, perform the following steps. When you route the cables from the side of the camera unit, see "Connecting to the side conduit hole".

a) If you use the camera with its factory setting

The preparation is completed.

b) If you use the LAN cable only

- 1 Loosen the four screws of the dome casing using the supplied wrench and remove the dome casing.
- 2 Loosen the three holder plate fixing screws on the bottom to remove the holder plate and cable holder.
- 3 Disconnect all the cables from the connectors and remove them from the cable holder.
- 4 Insert the LAN cable through the hole of the LAN cable holder (replace the cable holder with the LAN cable holder).
- 5 Insert the LAN cable through the bottom hole and adjust the length of the LAN cable from the hole to the LAN port.
- 6 Connect the LAN cable to the LAN port.
- 7 Attach the removed holder plate to the bottom hole with the three holder plate fixing screws.

- c) For other cases
- 1 Loosen the four screws of the dome casing using the supplied wrench and remove the dome casing.
- 2 Loosen the three holder plate fixing screws to remove the holder plate and cable holder.
- 3 Remove all the cables from the cable holder and disconnect unnecessary cables from the connectors.

Notes

- For case b), if you use your own LAN cable, keep its diameter ø5.0 mm (7/32 inches) - ø6.0 mm (1/4 inches). Otherwise, waterproof the bottom hole.
- For case c), if you need to waterproof the camera, see "Important precautions" overleaf.
- Do not pull on any cables forcefully, as a connection may become loose.
- If the cables are removed from the guides, pass the cables through the guides and secure them again.
- For case c), do not attach the cable plate and cable holder.

- d) Connecting to the side conduit hole
- All the cables are connected to the camera through the bottom hole at the factory. If you want to use the side conduit hole, perform the following steps:
 - 1 Remove the conduit hole cover.
 - 2 Loosen the three holder plate fixing screws on the bottom to remove the holder plate and cable holder.
 - 3 Disconnect all the cables from the connectors, and pull them out through the bottom hole.
 - 4 Insert the necessary cables through the pipe, then through the supplied cable holder (for conduit), and finally through the side conduit hole. (D-c-2)
 - 5 Connect the cables to the connectors.
 - 6 Secure the cables through the guides. (D-c-1)
 - 7 Screw the removed conduit hole cover into the bottom hole.

Notes

- If the bottom hole is dirty, the conduit hole cover cannot be fixed firmly. In this case, moisture may leak into the casing and this may cause a malfunction. Wipe off the dust with a soft cloth, and fix the conduit hole cover firmly.
- Cover the joint part of the pipe/cover with silicon sealant, etc. to prevent moisture from getting inside the casing.
- The holder plate and the cable holder are not necessary when you attach the conduit hole cover to the bottom hole.
- Be careful not to drop the conduit hole cover and nut (B-7) when installing or removing the camera.
- For details on using the supplied cable holder (for conduit), see "Important precautions" overleaf.

Installation

WARNING

- If you attach the camera in the height such as the wall or the ceiling, etc., entrust the installation to an experienced contractor or installer.
- If you install the camera at a height, ensure that the installation location and its material are strong enough to withstand a weight of 15 kg (33 lb 11 oz) or more, and then install the camera securely. If the ceiling is not strong enough, the camera may fall and cause serious injury.
- To prevent the camera from falling, make sure to attach the supplied wire rope.
- If you attach the camera to the ceiling, check periodically, at least once a year, to ensure that the connection has not loosened. If conditions warrant, make this periodic check more frequently.

Deciding the Installation Location of the Camera

After deciding the direction in which the camera will shoot, make the required hole (ø73 mm (2 7/8 inches)) for the connecting cables using the supplied template. Then decide the four mounting hole positions to install the bracket.

Mounting screws
The supplied bracket is provided with eight ø4.5 mm (3/16 inches) mounting holes. Install the bracket on a ceiling or wall with screws through four mounting holes: two 83.5 mm (3 3/8 inches)-pitched holes or four 85.7 mm (3 3/8 inches)-pitched holes. The required mounting screws differ depending on the installation location and its material. (Mounting screws are not supplied.)

Steel wall or ceiling: Use M4 bolts and nuts.
Wooden wall or ceiling: Use M4 tapping screws. The panel thickness must be 15 mm (5/8 inches) or more.
Concrete wall: Use anchors, bolts and plugs suitable for concrete walls.
Junction box: Use screws to match the holes on the junction box.

WARNING

The required mounting screws differ depending on the installation location and its material. If you do not secure the camera with the appropriate mounting screws, the camera may fall off.

Installing the Camera

- 1 Remove the dome casing.
 - ① Loosen the screws with the wrench (supplied).
 - ② Pull up and remove the dome casing. When the screw catches on the screw hole, pull up the screw.
- 2 Install the supplied bracket on the ceiling or wall. Refer to "Mounting screws" for screws to be used.
- 3 Fix the supplied wire rope to the camera unit and the ceiling or wall.
 - ① Fix the wire rope with the supplied Screw Ⓞ M4 × 8 to the hole for the wire rope on the bottom of the camera unit.
 - ② Fix the wire rope to the ceiling or wall.
- 4 Attach the camera unit to the bracket with the supplied four camera unit mounting screws. The screws have a fall-prevention mechanism. The screws inserted into the screw holes of the camera unit do not fall even if you turn the camera unit upside down. Insert the two holders to any two of the four grooves on the bracket. Turn the camera clockwise until the locating pins snap to the holes on the holders. Then the four camera installation holes will align the projections on the bracket accordingly. There are four projections with an angle of 90 degrees, so you can select one of four directions. Then tighten the four camera unit mounting screws to attach the camera unit to the bracket through the camera installation holes.

Note

If you cannot use screws on a ceiling or wall, or if you want to make the camera less conspicuous, use the YT-ICB45 in-ceiling bracket (optional) with which you can mount the camera on the ceiling. For this model, install the camera to the **D** position on the side brackets of YT-ICB45. Refer to the Installation Instructions of YT-ICB45 for detail information.

(continued overleaf)

G

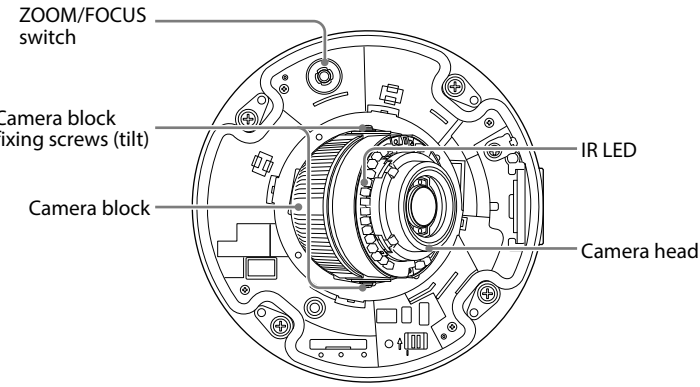

G-1

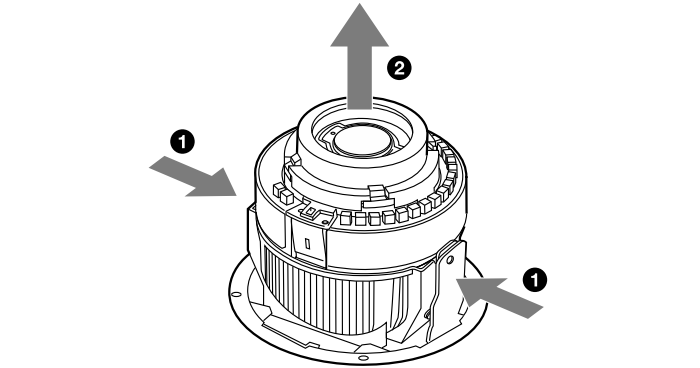

G-2

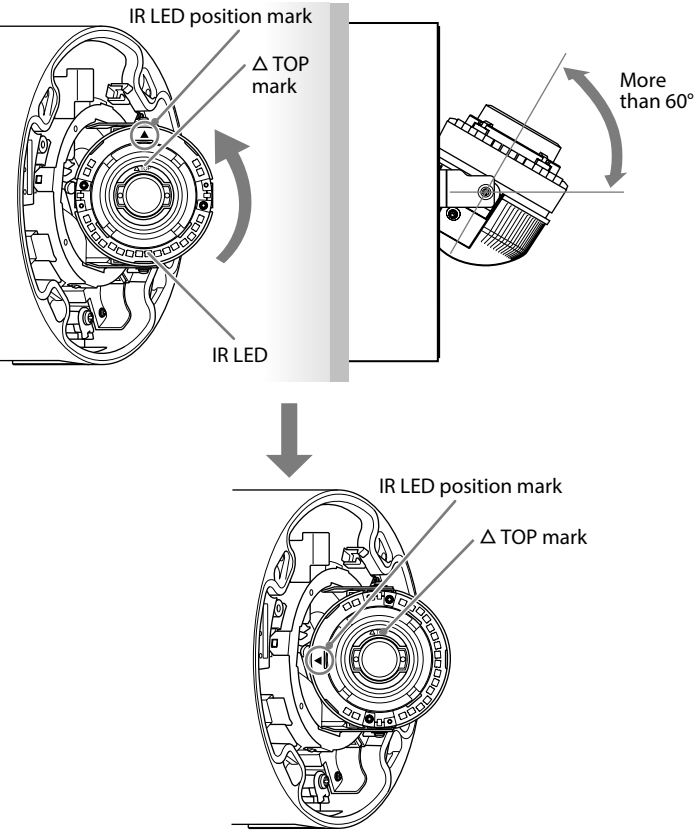

G-3

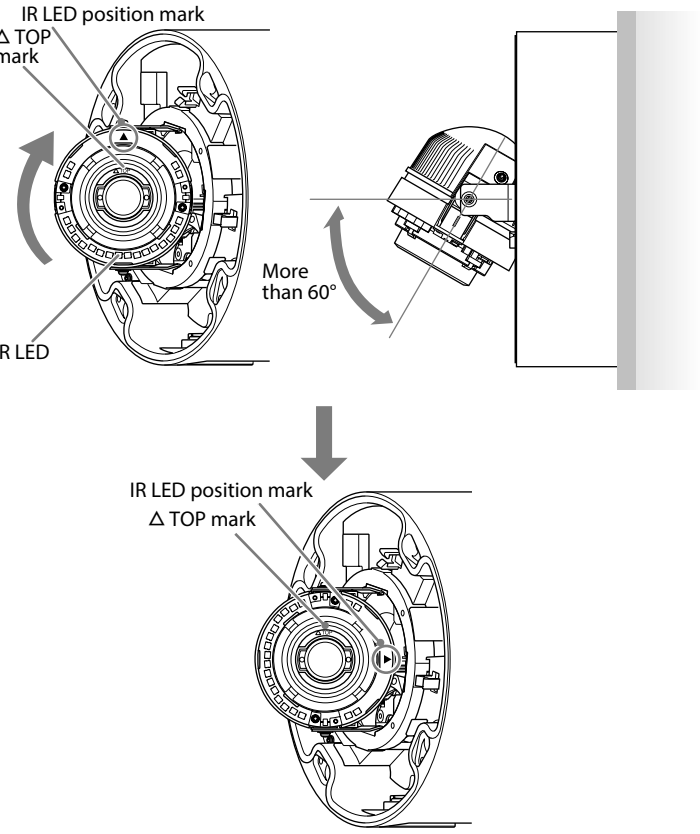

G-4

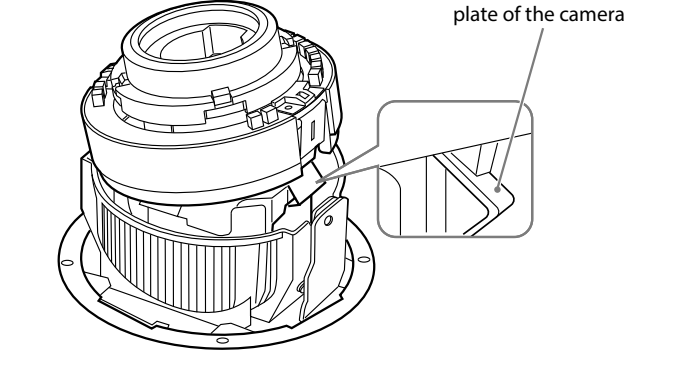

G-5

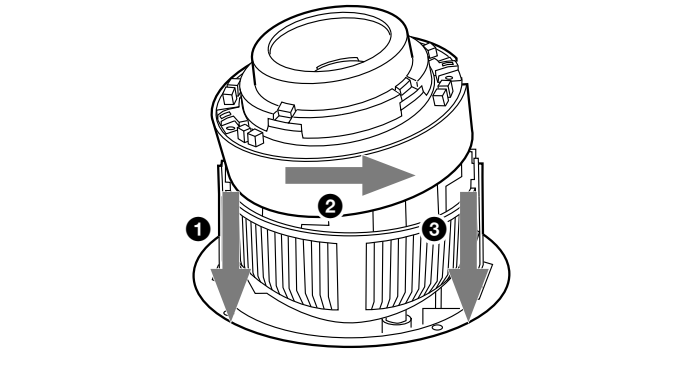

G-6

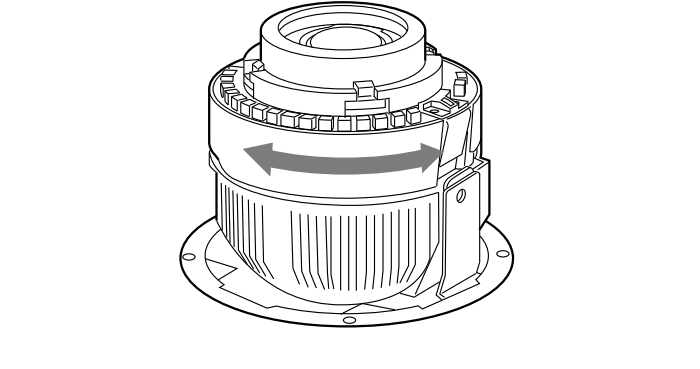

H

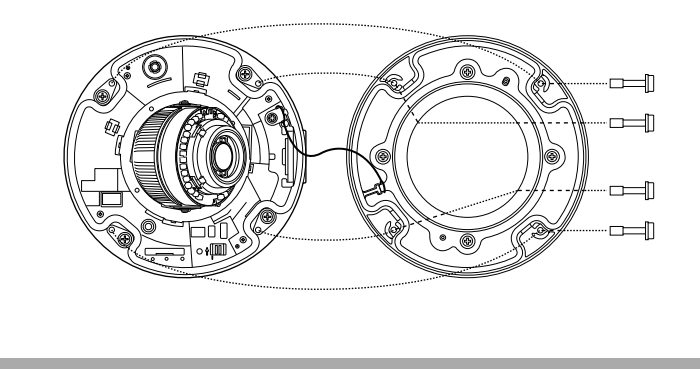

I

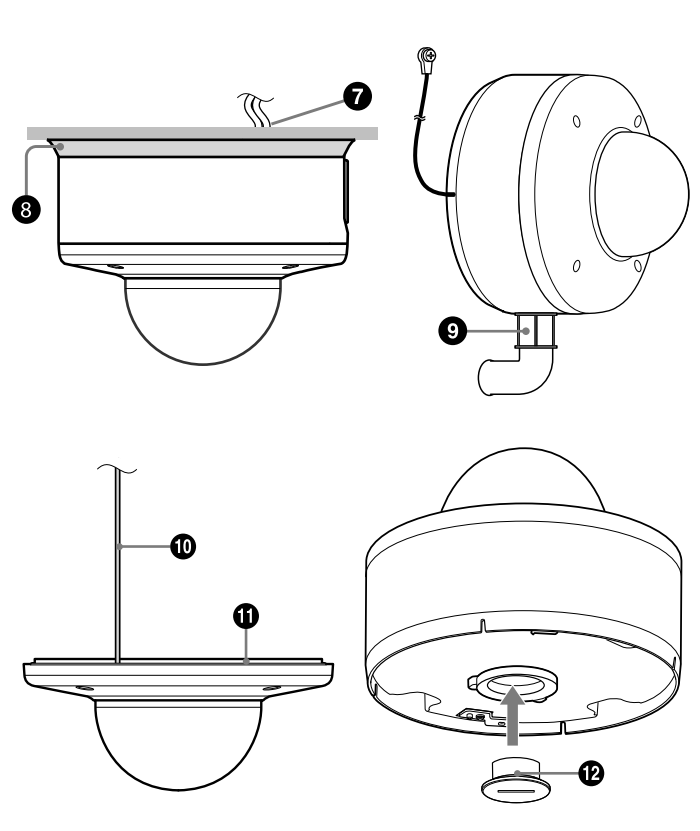
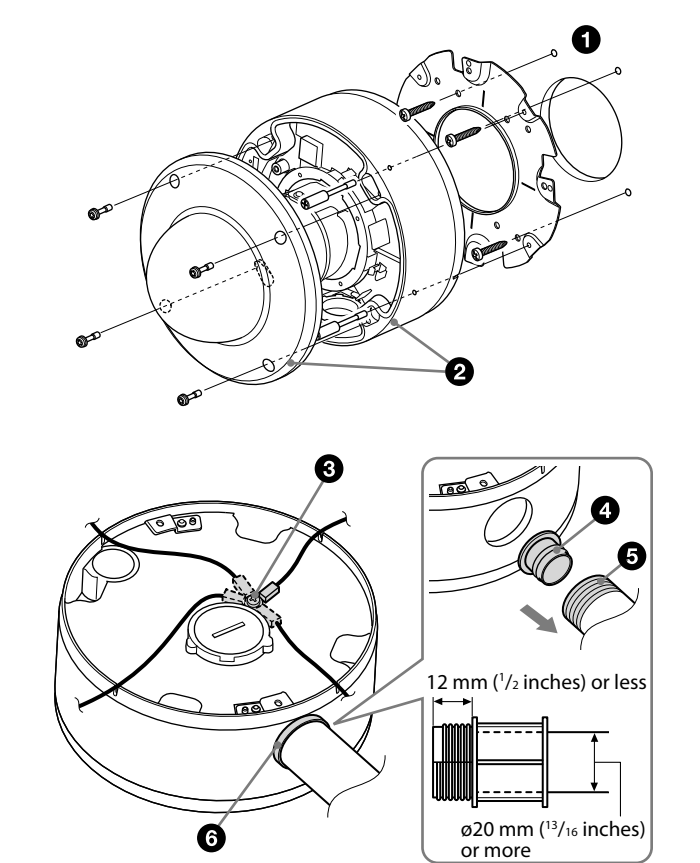

J

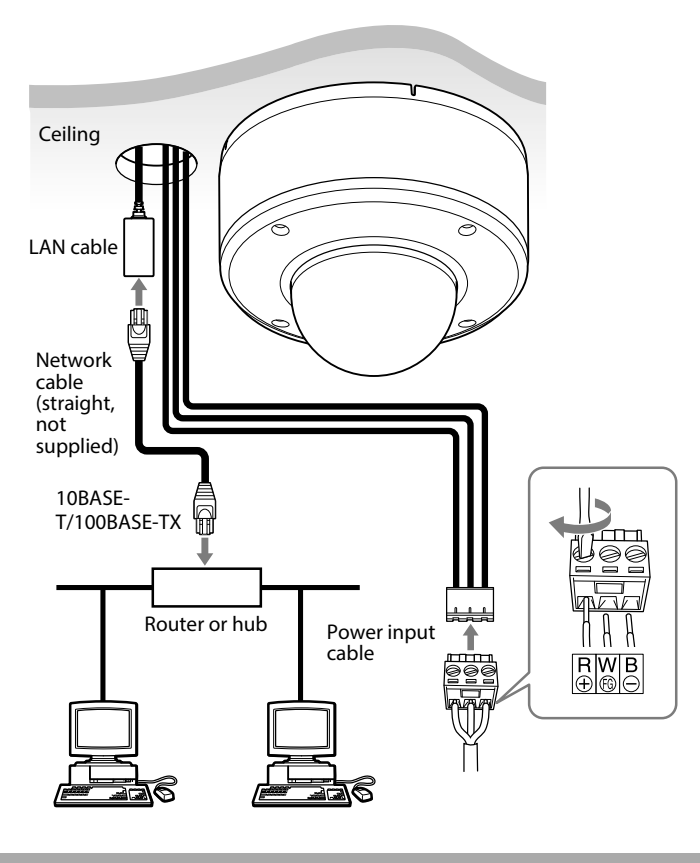

K

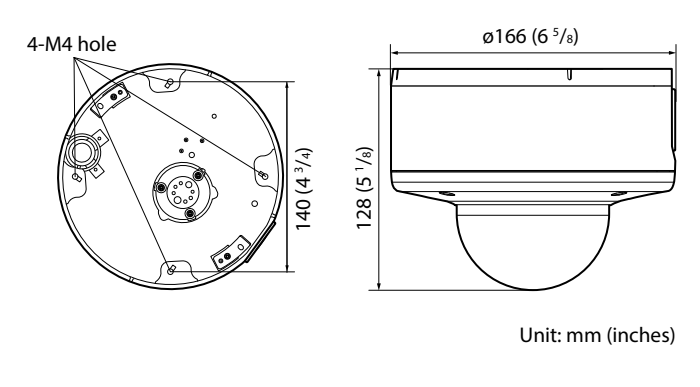

Adjusting the position of IR LED

You can adjust all tilt and rotation positions. There is no screw for rotation and Base(PAN) position. Turn the camera head to rotate the camera. You can invert the image by using the setting menu.

1 Loosen the camera block fixing screws. Loosen the two camera block fixing screws (tilt).

2 Adjust the camera to turn the lens in the desired direction.

3 If the camera is installed on the wall and the tilt angle is more than 60°, adjust the position of the IR LED depending on the following installation conditions (②-(1), ②-(2)). If the IR LED is blocked when the lens is pointed downwards, rotate the camera head 180°, then select the invert the image function from the setting menu to adjust the top and bottom position of the image. For other cases, use the camera in the factory default setting.

① Holding both sides of Base(PAN) (arrow ①), hold the black metal part on the camera head and pull up (arrow ②) to remove the camera head. (G-1)

Note

If the harness is removed from the connector, connect it to the connector, again.

② Turn the camera head clockwise or counterclockwise (90°) to adjust the position of the IR LED. The adjustment position will depend on the following installation conditions.

- (1) When the camera is pointing to your left (when you are facing in front of the camera) (G-2) Turn the camera head counterclockwise (90°) to move the I mark to "2" on the plate of the camera.
 - (2) When the camera is pointing to your right (when you are facing in front of the camera) (G-3) Turn the camera head clockwise (90°) to move the I mark to "3" on the plate of the camera.
- ③ Holding Base(PAN), insert the camera head to the camera block.** Before inserting the camera head, check if the clutches (two positions) on the camera head are outside of the plates of the camera. (G-4)
- (1) Slide one side of the camera head downwards (arrow ①), (G-5)
 - (2) Pushing the camera head to the opposite direction (arrow ②), slide it downwards (arrow ③) and insert into the camera block. (G-5)
 - (3) Tighten the two camera block fixing screws to fix the camera. Check if the camera head and camera block can be rotated smoothly clockwise and counterclockwise. (G-6)

Note

The I mark is positioned to "1" on the plate of the camera at the factory.

4 Slide the ZOOM/FOCUS switch to W/T to adjust the angle of view.

5 Hold down ZOOM/FOCUS switch for a moment to adjust the focus automatically.

6 Repeat step 1 to 5 until the coverage and the focus are determined.

Notes

- If you do not follow the steps above to adjust the direction of the IR LED, IR LED working distance or the image quality may be affected due to the IR LED being blocked.
- When you insert the camera head to the camera block, be careful not to shut the harness between the clutch on the camera head and the plate on the camera.
- After you insert the camera head into the camera block, check if the clutches on the camera head (two positions) are inserted properly in the concave portion of the camera block.
- When you adjust the camera head angle without loosening camera block fixing screw, an internal part may be damaged.
- If you cannot achieve satisfactory focus by holding down the ZOOM/FOCUS switch due to the shooting environment, slide the ZOOM/FOCUS switch level to N/F to focus manually.
- Do not turn off this unit as soon as the focus is adjusted. Turn off after five minutes have passed since the focus was adjusted.
- Poor focus may also be caused by the dome case assembly. Readjust the focus using the system menu.
- For details, refer to the User's Guide of the equipment.
- When the dome casing is attached it may be visible in the monitor depending on zoom and rotation. Also, distortion might be observed in images shot outside the specified optical area.
- Do not turn the camera block fixing screws (tilt) more than 0.5 to 1 turn, as they may become loose and fall out.

Attaching the Dome Casing

Fix the dome casing and the camera unit. Align four screw holes on the dome casing with those on the camera unit, and tighten four screws with the supplied wrench to secure the dome casing.

Note

Make sure the safety cord does not get caught between the dome casing and camera unit. Rotate the cord and adjust the position of the cord.

Important precautions

- Despite the fact that this unit is rated IP66, this section includes important precautions to prevent any malfunction caused by condensation and/or water ingress. Read the precautions below thoroughly before installing the unit.
- Make sure that the cables and/or connectors of the unit that join to the ones of the installation surface are waterproofed, before you install the unit. Otherwise, there may be a risk of water entering the unit through these cables.
 - Install the bracket and the camera on an even ceiling or wall, etc. (I-1)
 - Install the camera properly, using the supplied screws, while referring to the Installation Manual. (I-2)
 - When feeding the wire rope through one of the wiring slits, fix the wire rope with the supplied screw to the hole on the bottom of the unit according to which wiring slit is used. (I-3)
 - Use the supplied cable holder (for conduit) or seal the inside of the pipe to prevent moisture (condensation) entering the pipe. (I-4)
 - Use a pipe/joint of 3/4 inches-14 NPT or M27 2.0 mm (1/2 inches)-pitched) with a thread length of 12 mm or less, and an internal diameter is at least ø20 mm. Any threaded parts should be waterproofed with a sealant material. (I-5)
 - When connecting a cable gland to the side conduit hole, use the cable gland which has following conditions:
 - connectable to the side conduit hole with an opening of ø27 mm (1 1/8 inches)
 - a thread length of 12 mm (1/2 inches) or less
 - waterproof performance suited to the installation environment
 - When connecting flanged pipe to the side conduit hole, seal all around the flange to prevent water entering. Otherwise water enters the unit through the gap between the flange and unit. (I-6)
 - The bottom of this unit is designed to be waterproof. However, in case b) or c) in the Preparations section, when connecting the cable to this unit, install this unit in a waterproof enclosure or on a waterproof ceiling to prevent water ingress. Alternatively, seal the bottom hole. (I-7) Cover the joint between the ceiling and the unit with a sealant material to prevent water ingress. (I-8)

- Install the camera on a wall lengthwise.**
- Position the side conduit hole downward to prevent water ingress from cables. (I-9)
 - In an environment of high temperature and exposed to direct sunlight, install a SNCA-WP602 Weather protector (not supplied). The Weather protector can also protect against rain and snow.

Notes on assembly

- Make sure the safety cord does not get caught between the dome casing and camera unit. (I-10)
- Before attaching the dome casing to the camera unit, make sure the waterproof rubber gasket is clean and fits in the groove of the joint surface properly. (I-11)
- Before attaching the conduit hole cover to the bottom hole, make sure the waterproof rubber gasket is clean and fits in the groove properly. (I-12)

Connection

Connecting to the Network

Connect the LAN port of the camera to a router or hub in the network using a commercially available network cable (not supplied).

Connecting the Power Source

- There are three ways to supply the power source to this camera, as follows.
- 12 V DC
 - 24 V AC
 - Power supply equipment pursuant to IEEE802.3af/at (PoE/PoE+ system)
- *PoE means Power over Ethernet.

Notes

- Do not turn off the camera immediately after turning it on. Wait for at least five minutes before turning off the camera.
- Do not connect the power input cable if power is supplied by a PoE system.
- When power is supplied by IEEE802.3af (PoE) equipment, do not set the POWER switch to PoE+, AC, DC.

Connecting to 12 V DC or 24 V AC source

- Connect the power input cable of the camera to a 12 V DC or 24 V AC source.
- Use a 12 V DC or 24 V AC source isolated from 100 to 240 V AC. Each usable voltage range is as follows. (Assured range of the voltage the camera is receiving (receiving-end voltage))
 - 12 V DC: 10.8 V to 13.2 V
 - 24 V AC: 19.2 V to 28.8 V
 - In the USA, The product shall be powered by a UL Listed Class 2 Power Supply Only.
 - In Canada, The product shall be powered by a CSA certified Class 2 Power Supply Only
- Use UL cable (VW-1 style 10368) for these connections.

Recommended cable

When the receiving-end voltage of the camera is 12 V DC:			
CABLE(AWG)	#14	#16	#18
Max. length(m)	24	15	9

When the receiving-end voltage of the camera is 24 V AC:			
CABLE(AWG)	#20	#22	#24
Max. length(m)	100	63	39

Connecting to the power supply equipment pursuant to IEEE802.3af/at

The power supply equipment pursuant to IEEE802.3af/at supplies the power through a commercially available network cable. For details, refer to the Instruction Manual of the equipment.

Note

If you connect the camera to power supply equipment pursuant to IEEE802.3at, the equipment may limit the power supply and the camera may stop operating. For details, refer to the instruction manual of the power supply equipment.

Connecting the I/O Cable

Connect the wires of the I/O cable as follows:

Wiring diagram for sensor input

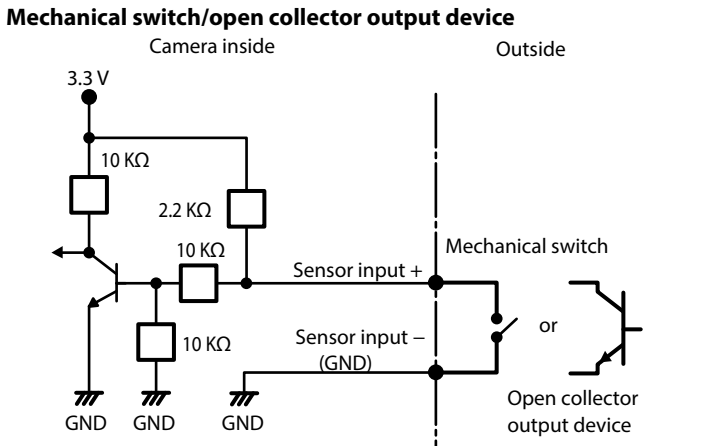

Wiring diagram for alarm output

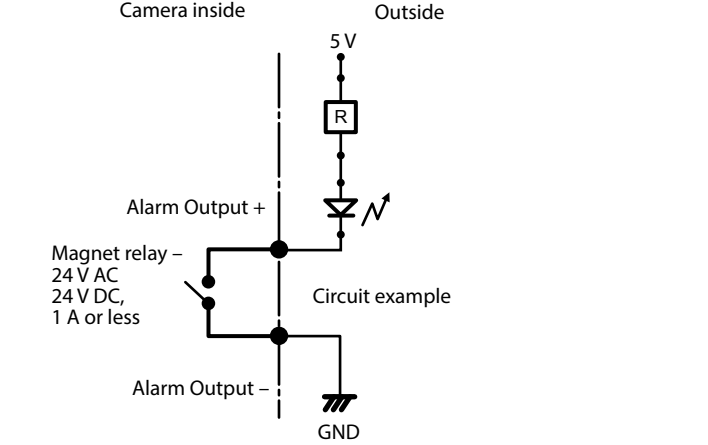

Specifications

Compression	
Video compression format	JPEG/H.264
Audio compression format	G.711/G.726/AAC
Maximum frame rate	60 fps
Camera	
IR LED	20 pcs
IR working distance	30 m (50 IRE)
Signal system	NTSC color system/PAL color system (switchable)
Image device	SNC-VM602R
	1/3type CMOS (Exmor)
Effective picture elements:	Approx. 1,370,000
	SNC-VM632R
Effective picture elements:	Approx. 2,140,000
	SNC-VM632R
Synchronization	Internal synchronization
	SNC-VM602R: 600 TV lines (analog video)
Horizontal resolution	SNC-VM632R: 700 TV lines (monitor display ratio 4:3)
	More than 50 dB (Auto gain control maximum rate 0 dB)
Video S/N	F1.2/View-DR Off/VE* Off/Auto gain control maximum rate MAX/50 IRE (IPI)/30 fps
	SNC-VM602R
Minimum illumination	Color: 0.05 lx
	Black & White: 0 lx (IR ON)
SNC-VM632R	Color: 0.10 lx
	Black & White: 0 lx (IR ON)
* VE stands for Visibility Enhancer.	
Lens	
Focal length	3.0 mm to 9.0 mm
Maximum relative aperture	F1.2 ~ F2.1
View angle	SNC-VM602R: 1280 × 1024 (aspect ratio 5:4)
	Vertical: 73.1° to 25.5°
Horizontal: 92.9° to 31.8°	SNC-VM632R: 1920 × 1080 (aspect ratio 16:9)
	Vertical: 56.9° to 20.1°
Horizontal: 105.3° to 35.6°	Pan: -192° to +192°
	Tilt: -7° to +75°
Rotation: -99° to +180°	300 mm
Interface	
LAN port (PoE/PoE+)	10BASE-T/100BASE-TX, auto negotiation (RJ-45)
I/O port	Sensor input: × 2, make contact, break contact
	Alarm output: × 2 (maximum 24 V AC/DC, 1A) (mechanical relay outputs electrically isolated from the camera)
SD memory card slot	VIDEO OUT: BNC, 1.0 Vp-p, 75 ohms, unbalanced, sync negative
	Minijack (monaural)
Microphone input*	Plug-in-power supported (rated voltage: 2.5 V DC)
	Recommended load impedance: 2.2 kΩ
Line input*	Minijack (monaural)
	* The microphone input and the line input are switchable with operating menu.
Line output	Minijack (monaural), Maximum output level: 1 Vrms
Others	
Power supply	12 V DC ± 10%
	24 V AC ± 20%, 50 Hz/60 Hz
Power consumption	IEEE802.3at compliant (PoE/PoE+ system)
	Max. 22W (AC 24 V/DC 12 V)
Operating temperature	Max. 18W (IEEE8.2.3af (PoE+))
	Max. 12.8W (IEEE8.2.3af (PoE))
Start temperature:	-30°C to +60°C (-22°F to +140°F) (IR OFF, DIP switch PoE+, AC, DC)
	-30°C to +50°C (-22°F to +122°F) (IR ON, DIP switch PoE+, AC, DC)
0°C to 60°C (32°F to 140°F) (IR OFF, DIP switch PoE)	0°C to 50°C (32°F to 122°F) (IR ON, DIP switch PoE)
	Working temperature:
-40°C to +60°C (-40°F to +140°F) (IR OFF, DIP switch PoE+, AC, DC)	-40°C to +50°C (-40°F to +122°F) (IR ON, DIP switch PoE+, AC, DC)
	-10°C to +60°C (14°F to 140°F) (IR OFF, DIP switch PoE)
-10°C to +50°C (14°F to 122°F) (IR ON, DIP switch PoE)	-20°C to +60°C (-4°F to +140°F)
	Operating humidity
Storage temperature	20% to 90%
	Storage humidity
Dimensions (diameter/height)	20% to 95%
	166 mm × 128 mm (6 5/8 inches × 5 1/8 inches), not including the projecting parts
Mass	Approx. 1,730 g (3 lb 13 oz), not including the bracket
	Supplied accessories
CD-ROM (supplied programs) (1), Bracket (1), Template (1), Wire rope (1), LAN cable holder (1), Camera unit mounting screws (4), Screw (M4 × 8) (2), Wrench (1), Installation Manual (this document) (1 set), Safety Regulations (1 set), Cable holder (for conduit) (1)	

Optional accessory	
In-ceiling bracket	YT-ICB45*
* Use the fixture position D on the bracket.	
Weather protector SNCA-WP602	
Design and specifications are subject to change without notice.	
Recommendation of Periodic Inspections	
In case using this device over an extended period of time, please have it inspected periodically for safe use.	
It may appear flawless, but the components may have deteriorated over time, which may cause a malfunction or accident.	
For details, please consult the store of purchase or an authorized Sony dealer.	